

From the World of DragonQuest

The Palace of Ontoncle

The Palace of Ontoncle is a fantasy role-playing adventure scenario that can be used in conjunction with SPI's *DragonQuest*. The gamesmaster uses this booklet to describe the missions for the players and to guide them through the palace of an evil magician and his henchmen.

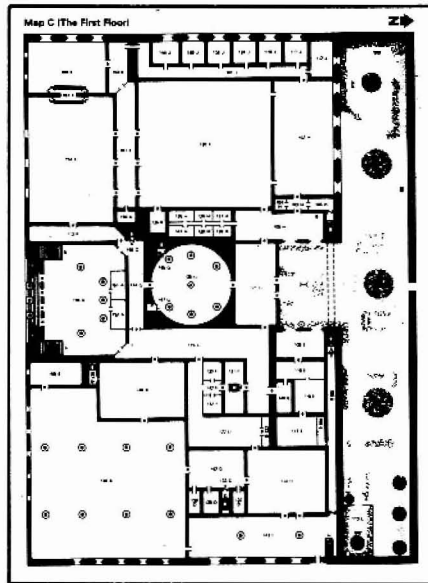

MAP C: THE FIRST FLOOR

In the golden days of the palace, the first floor was a center of much activity. Guests were received in the main hall at the front entrance (151-A). There were frequently balls and feasts in the Great Hall (120-K) and troubadours entertained in the East Room (149-B). Now, however, the first floor is almost completely abandoned.

**Available in
retail stores
for \$4.95**

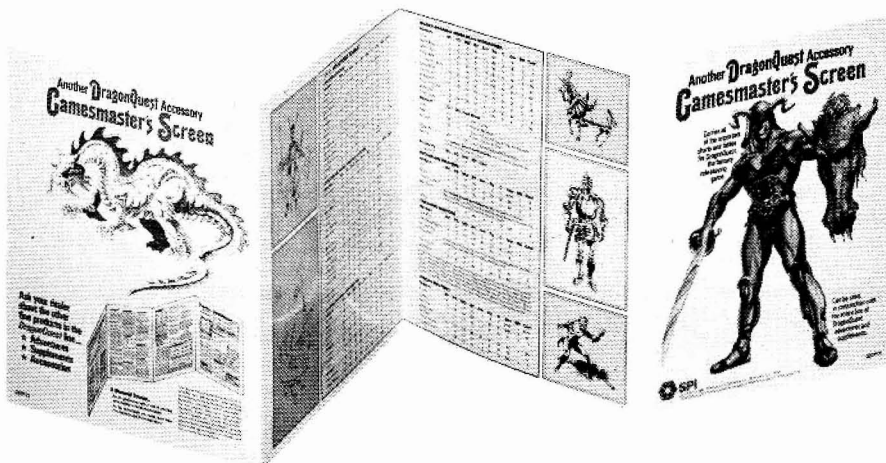

The *DragonQuest Gamesmaster Screen* is the perfect solution for every gamesmaster who has tired of looking through rule booklets for that one chart or table. All the important charts for the GM appear on one side, and the weapon's chart on the other side for the players. This 11" x 34" four-color screen folds down to fit inside the *DragonQuest* box.

**Now available
through retail dealers
nationwide for \$3.50**

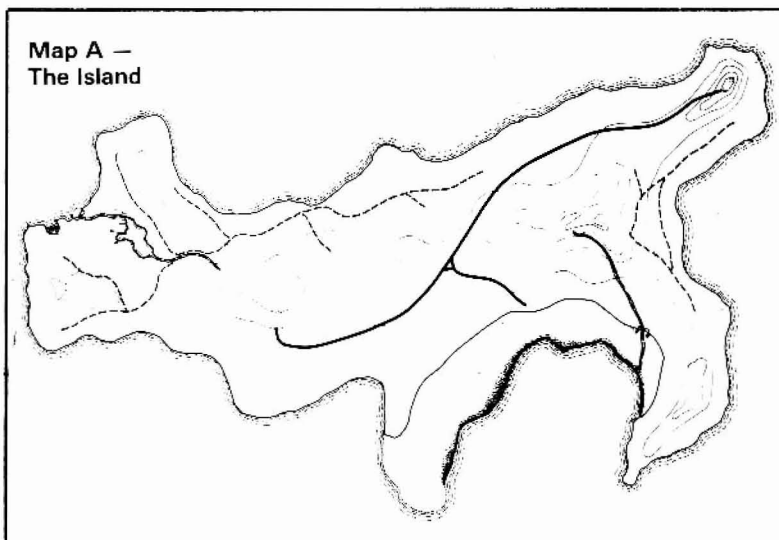

The Blade of Allectus

The Blade of Allectus, the second *DragonQuest* adventure, is a playing aid for the Gamesmaster. The adventure turns upon a rescue attempt by a band of adventurers, who sail to an island to save a kidnapped Duke. *The Blade of Allectus* contains a rules booklet with ten maps and complete descriptions of the island and the various structures upon it.

**Available nationwide in
retail outlets for \$4.95!**